

These particulars, whilst believed to be accurate are set out as a general outline only for guidance and do not constitute any part of an offer or contract. Intending purchasers should not rely on them as statements or representations of fact, but must satisfy themselves by inspection or otherwise as to their accuracy. No person in this firm's employment has the authority to make or give any representation or warranty in respect of the property.

Whilst every attempt has been made to ensure the accuracy of the floorplan contained here, measurements of doors, windows, rooms and other items are approximate and no responsibility is taken for any error. This plan is for illustrative purposes only and should be used as such by any prospective purchaser. The services, systems and appliances shown have not been tested and no guarantee as to their operability or efficiency can be given.

Made with Metropix ©2024

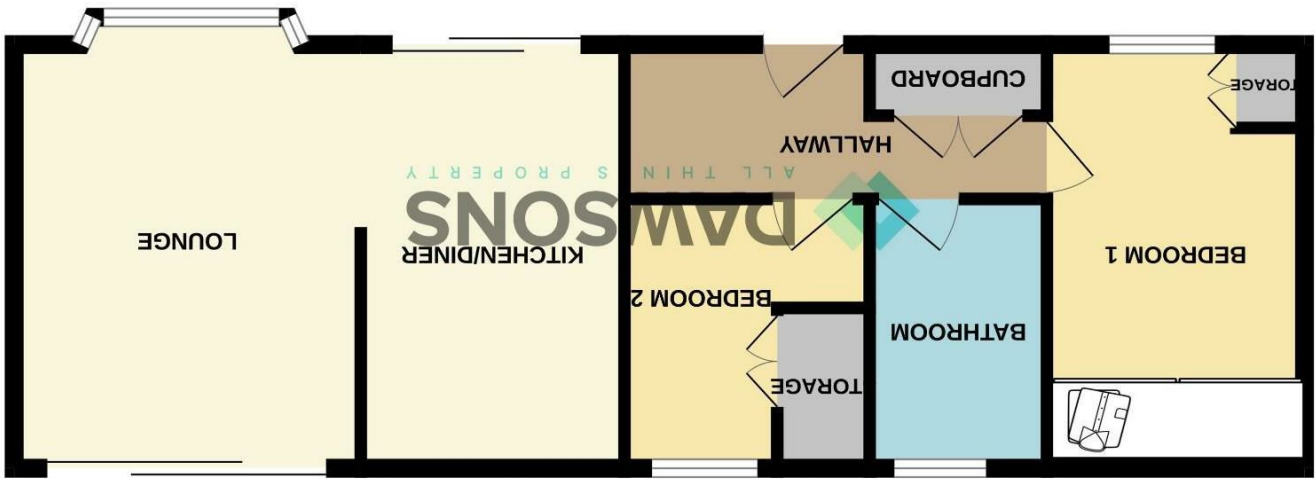

GROUND FLOOR

FLOOR PLAN



AREA MAP

GENERAL INFORMATION

An attractive two bedroom detached park home situated in an established development for the over 50's. Nestled in a serene retirement park setting, this modernized two-bedroom park home presents a comfortable and convenient lifestyle for retirees. Step into a hallway that seamlessly guides you through an open plan layout, effortlessly integrating the lounge, dining area, and fitted kitchen and also offering two bedrooms and a stylish shower room. Outside, a raised seating area provides a perfect spot for relaxation amidst the tranquil surroundings, complemented by a dedicated parking space for convenience. With its modern comforts, practical amenities, and peaceful ambiance, this property offers a delightful retreat for those seeking low-maintenance living in a retirement community. Viewing is recommended. Freehold- site fees £186.37 per month, EPC - Exempt.

FULL DESCRIPTION

Entrance Hallway
12'03 x 4'08 (3.73m x 1.42m)

Kitchen/Dining Area
13'03 x 8'03 (4.04m x 2.51m)

Lounge
13'03 x 10'10 (4.04m x 3.30m)

Bedroom 1
11'04 x 8'01 (3.45m x 2.46m)

Bathroom
8'04 x 5'06 (2.54m x 1.68m)

Bedroom 2
8'05 x 7'08 (2.57m x 2.34m)



Tenure

Freehold.
There are site fees of £186.37 per month. Annual review is January. There are site regulations, please speak to a member of staff for more information.

Council Tax Band

C

Services

Mains electric, water & drainage (water and electricity are metered by the site)
LPG Gas.
The current sellers do not have broadband. Please refer to Ofcom checker for further information.
The current sellers have advised there are no known restrictions or issues with mobile coverage. Please refer to Ofcom checker for further information.

